

**Nozzle Cleaning Inspection Machine**

# SCI-CPX II

**Solution for Panasonic NPM systems!!**

**All come true with one!**

01

**Cleaning**

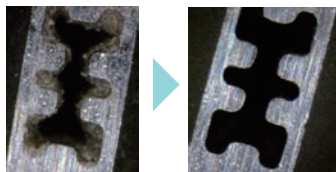

Cleaning the nozzle perfectly with ultrasonic and vacuum system

02

**Inspection**



Checking the NG nozzle by inspection system (nozzle tip checking is option)

03

**Traceability**



Traceability system for each nozzle

04

**Connected solution**

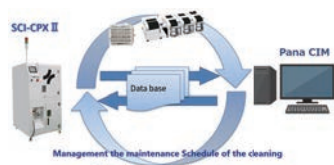

Can be linked with the factory systems (Pana CIM)



**Renew with more nozzles!**

## Corresponding changer and nozzle

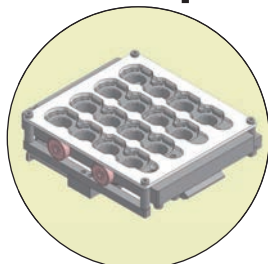

Standard changer

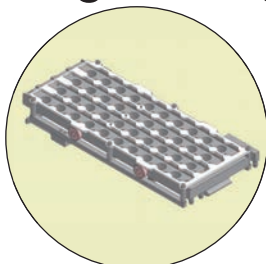

Expansion changer

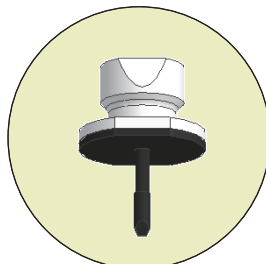

Standard nozzle for 12/16 head

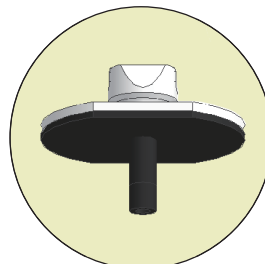

Standard nozzle for 8 head

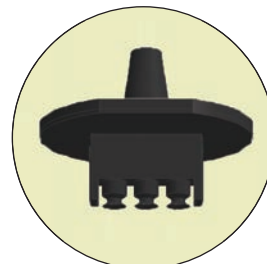

Standard nozzle for 2/3/4 head (option)

**Easy set with nozzle changer!**

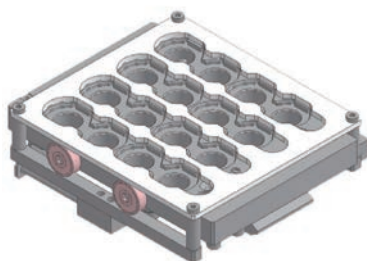

**Video**

## » Cleaning effect

Before



After



## » Cleaning mechanism

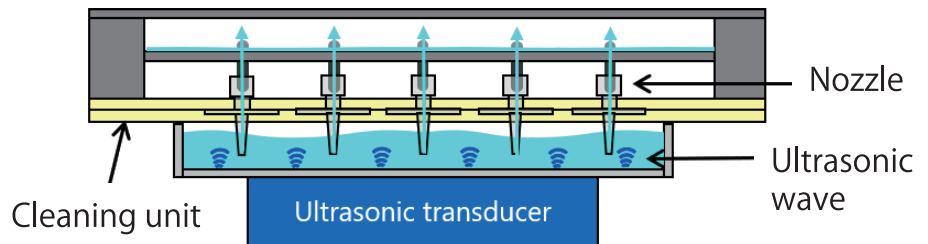

Ultrasonic vibrated water thoroughly passes through every nozzle hole. Nozzle tips and holes can be cleaned perfectly without leaving any residues adhered inside the nozzles.

## » Inspection / management

### Laser inspection

Inspect the nozzle clogging by laser.

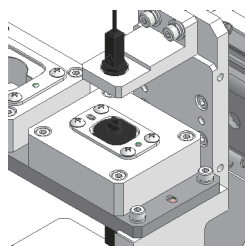

### Camera Inspection (Optional)

Inspect the dirty from Nozzle tip and all database log managed by PC.

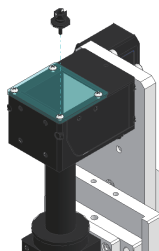

### NG Box (Optional)

Move to a dedicated stand to prevent accidental use of the nozzle if the inspection was NG.

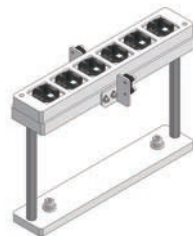

Can be checked, managed, and linked on a PC

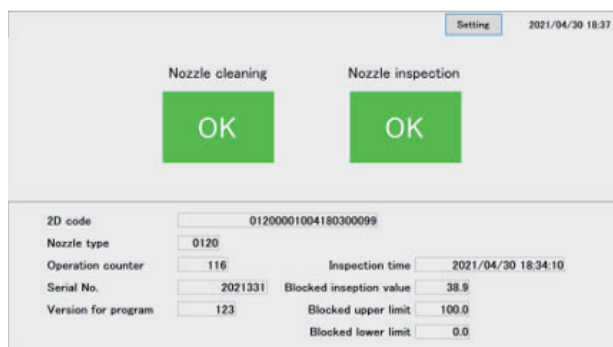

"Cleaning history", "inspection result" and "inspection image" are linked to the nozzle ID and stored in management PC.

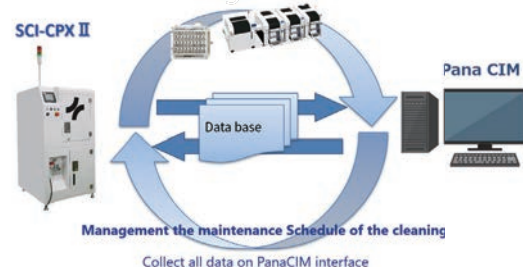

Can be linked with the factory systems (Pana CIM)

## » Specification

Model	SCI-CPX II
Dimension	W 800 D 800 H 1,513mm (incl. signal tower H 1,920mm)
Weight	approx.280kg
Power	AC100~240V 220VA 50/60Hz
Ultrasonic	Frequency $38 \pm 4$ kHz Output 60W
Air	0.5MPa 300NL/min
Available nozzle	Nozzle for 12/16 head, 8 head, 2/3/4 head (Optional)
Takt time	Nozzle for 12/16 head 32pc/unit : approx.31min Nozzle for 8 head 16pc/unit : approx.16min

Specifications are subject to change without notice. 2021.11

Manufacturer

**SAWA Co., Ltd.**

SAWA

2-17-1 Tsudayamate, Hirakata-shi,  
Osaka 573-0127, JAPAN

TEL: +81-72-859-7286

FAX: +81-72-859-7287

MAIL [info@sawa-corp.co.jp](mailto:info@sawa-corp.co.jp)

URL <http://www.sawa-corp.co.jp>



**SUSTAINABLE  
DEVELOPMENT  
GOALS**

SAWA Corporation supports the Sustainable Development Goals (SDGs).